



RESORT GUIDE



Arrowwood[®]
LODGE AT BRAINERD LAKES

by CLUBHOUSE[®]

WELCOME



SPACIOUS ACCOMMODATIONS



FLEXIBLE MEETING SPACE



AWARD WINNING CUISINE



The Arrowwood Lodge at Brainerd Lakes offers a natural, rustic style with the cozy warmth of natural wood, stone fireplaces and sweeping views.

LODGE AMENITIES

- 102 luxuriously appointed and spacious guestrooms
 - » 6 multi-room themed suites
 - » 8 ADA approved accessible rooms
- Complimentary hot breakfast buffet with weekday stay
- Complimentary Wi-Fi throughout the property
- 7,000 square feet of flexible meeting space
- On-site restaurant and bar
- Room service available from 11 a.m. until 9 p.m.
- 30,000 square-foot indoor waterpark
- Indoor/outdoor hot tub
- Fitness center with gym-quality equipment
- Firepit for after-function gatherings



Your ideal Brainerd resort.

YEAR 'ROUND FUN

The Brainerd Lakes area of north central Minnesota is one of the top vacation destinations in the upper Midwest. Brainerd and the surrounding area offer a multitude of sports, recreation and entertainment for everyone. Fishing is popular throughout the year,

while winter attracts ice fishermen, snowmobilers and downhill and cross country skiers.

The warmer months attract those interested in activities such as boating, water skiing, golf and bicycling. If the weather is just plain lousy, you can relax at the Arrowwood Lodge and enjoy the waterpark and arcade, watch a video or check out the pub.

LODGING



2-BEDROOM KITCHEN SUITE



STANDARD DOUBLE QUEEN



CINEMA SUITE



KIDS SUITE



STANDARD ROOMS

Choose from our king or double queen rooms with separate living room area and sofa sleeper.

PREMIER SUITES

Ideal for larger families or groups of up to eight. (Adjoining rooms available.)

KITCHEN SUITE

2 bedroom, 1 bath suite featuring a full-sized kitchen and living room area. The first bedroom features a whirlpool for two and king bed, and the second has 2 queen beds.

CINEMA SUITE

3 room, 1 bath suite. First bedroom area features 2 queen beds. Walk through to the theater room with a pullout sectional couch, surround sound and big screen TV, complete with Play Station, X-Box and wet bar with mini refrigerator, microwave and coffeemaker. The second bedroom features a whirlpool for two and king bed.

KIDS SUITE

2 bedroom, 1 bath suite with king bed, whirlpool for two and separate room specially decorated for kids, complete with queen bunk beds and climbing wall. Living room area has

a large table and wet bar with full sink.

KING WHIRLPOOL

Escape to a romantic suite featuring a king bed, gas fireplace and whirlpool for two.

LOFT SUITE



First bedroom area features a queen bed. Walk past the bathroom and wet bar to the living area with gas fireplace and patio area. Up the steps, you'll discover two additional queen beds.



Up-north guestroom ambiance.



KING WHIRLPOOL

GUESTROOM AMENITIES

- Luxurious linens on pillow top mattresses
- Multiple flat screen TVs in each guestroom
- Spa quality bath products
- Coffeemaker, mini refrigerator and microwave
- Hair dryer, iron and ironing board
- Large executive work desk
- Many rooms with pullout sofa beds to accommodate additional guests

MEETINGS & EVENTS



RED & WHITE SAND BALLROOM



HEADWATERS BOARDROOM



BAIT & TACKLE MEETING ROOM



RED SANDS BALLROOM



The Arrowwood Lodge at Brainerd Lakes is more than a place to get away from it all; it is a premier meeting, conference and event facility. With over 7,000 square feet of flexible meeting and banquet space, it is one of the largest and newest facilities in



the Brainerd Lakes area. The lodge can accommodate meetings from 10 to 400+ attendees and everything in between. In addition to our state-of-the-art meeting space, we also offer an award winning culinary staff that will provide a breathtaking display of food.

HEADWATERS BOARDROOM

Above the lobby on the second floor, the Headwaters Boardroom is ideal for conducting small business meetings, training sessions, conference calls or interviews, with comfortable seating for up to 14.

BAIT & TACKLE / OJIBWA MEETING ROOMS

Also located on the second floor, the Bait & Tackle and Ojibwa meeting rooms are ideal for intimate executive retreats, planning sessions or small meetings. These rooms can also serve as breakout rooms for larger events.

RED & WHITE SAND BALLROOMS

The Sand Ballrooms are located on the main floor, adjacent to the lobby with walkout patio access, and can be divided into the Red Sand and White Sand rooms. The White Sand room is a two-story great hall space featuring a two-story, fieldstone gas fireplace. The Red Sand room also features a fieldstone gas fireplace and access to an outdoor fire pit. The versatility of the Sand Ballrooms makes them ideal for both social and business events, from wedding receptions and family reunions to seminars and trade shows. The possibilities are endless.

Premier event space in the Brainerd area.

MEETING ROOM AMENITIES

- 5,200 square-foot ballroom dividable into 2 breakout rooms
- One executive boardroom furnished in the deep, rich colors of the northwoods
- 2 meeting rooms, perfect for small to medium-sized breakout and training sessions
- Private group registration available
- Outdoor patio for additional banquet space
- Oversized ballroom doorways perfect for accommodating large freight
- Wi-Fi access in all meeting rooms and pre-function space
- Staging, banquet bars and hardwood dance floor
- In-house, full-service audio/visual department

MEETINGS & EVENTS

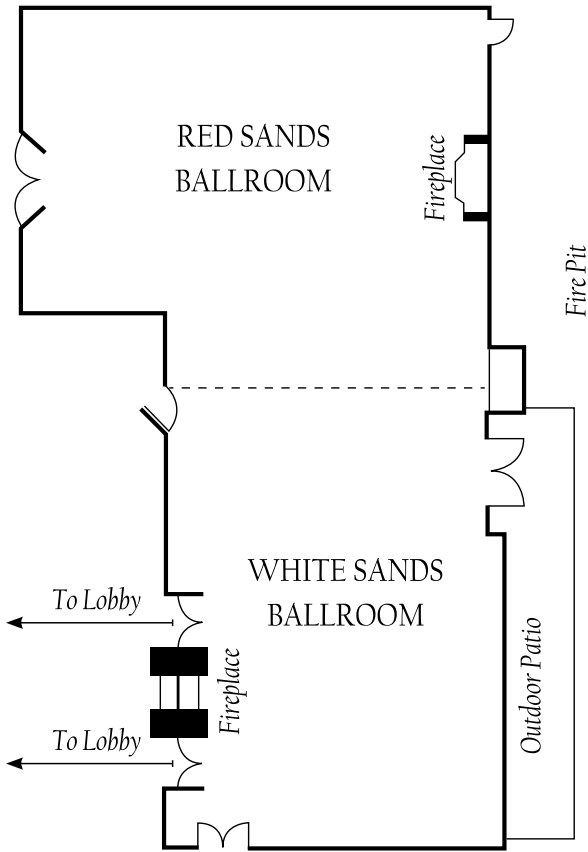

MAIN LEVEL

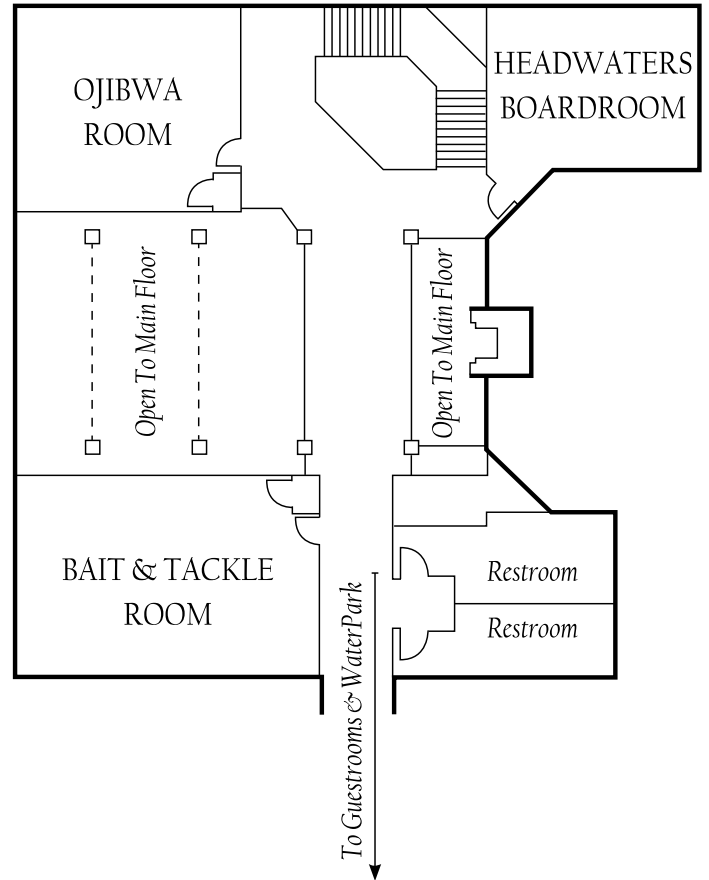

SECOND FLOOR



TRAPPER'S LOUNGE



PAUL & BABE'S ROOMS



PRIVATE DINING

MEETING ROOM CAPACITIES & DIMENSIONS

Room	Ceiling Height	Room Dimensions	Sq Ft	Reception	Banquet	Class-room	Theater	Half Rounds	U-Shape	Hollow Square	Display Tables	8 x 10 Booths	10 x 10 Booths
Headwaters Boardroom	8.4	24 x 19	456	n/a	n/a	n/a	n/a	n/a	n/a	n/a	n/a	n/a	n/a
Trapper's Lounge	8	24 x 23	552	50	n/a	n/a	n/a	n/a	n/a	n/a	n/a	n/a	n/a
Ojibwa	8.4	25 x 23	575	50	32	20	40	24	16	20	16	4	4
Bait & Tackle	8.4	33 x 23	759	70	48	30	60	30	30	36	22	6	6
Sands Ballroom	9 to 16.10	104 x 50	5,200	300	300	200	420	180	105	120	90	32	22
Red Sand	9	50 x 46	2,300	200	140	72	200	90	44	75	50	14	11
White Sand	16-10	40 x 58	2,320	200	140	90	200	90	48	80	40	18	12

WATERPARK ROOMS

Paul's Cabin	12	36 x 20	720	40	40	18	40	15	15	15	12	2	2
Babe's Barn	12	25 x 18	450	40	40	25	40	25	20	25	12	2	2

Ceiling Height & Room Dimensions are in feet.

**NOTE: The above capacities are strictly seating and tables only.
There are no provisions made for head table, staging, A/V equipment or any other additions.*

Event space for 400+ attendees.



OUTDOOR PATIO & FIREPIT AREA

RESORT AMENITIES



INDOOR / OUTDOOR WHIRLPOOL



FITNESS ROOM



AWARD WINNING CUISINE



PAUL BUNYAN WATERPARK is the premier Minnesota indoor waterpark in the Baxter/Brainerd area. Our 30,000 square-foot waterpark features a non-slip rubberized deck and has plenty of slides available for your lil' lumberjack. Additional features include:

- Tube slide
- Body slide: Be ready for an exhilarating ride as you rocket outside the building and back to land in the pool four stories below!
- Zero-depth entry pool
- Large tree house activity center with water cannons
- Life vests available
- Babe's Snack Bar
- Paul's Log Walk
- Lazy river
- Basketball hoops
- Indoor/outdoor hot tub with heated outdoor patio floor
- Paul's Place and Babe's Barn private party rooms
- Lifeguards on duty at all times to assure your safety

- Towels provided at the waterpark front desk
- Locker room with showers and coin-operated lockers
- No outside food or beverage allowed
- Please note that children under the age of 15 cannot be left unsupervised in the waterpark.

GOLD MINE ARCADE features 2,400 square feet of games, prizes and fun for all ages, including pool, air hockey, racing and hunting arcade games, skee ball and more! Earn tickets with each game and redeem them for prizes!



Premier event space in the Brainerd area.

DINING

Whether enjoying a center cut steak in our dining room, a glass of wine in the casual atmosphere of our bar, or an entrée in the comfort of your guestroom, the Arrowwood Lodge Grill & Bar provides an unforgettable experience that is sure to keep you coming back again and again.

The Grill & Bar proudly serves daily lunch and dinner specials, fresh pasta dishes, salads, hand-tossed pizzas with our own twist, sandwiches and homemade desserts. We have incorporated fresh and locally grown foods, and each dish is specifically prepared with calorie counts in mind.

FITNESS ROOM

Open 24/7 with all of the newest in fitness equipment.



Arrowwood[®]
LODGE AT BRAINERD LAKES
by CLUBHOUSE[®]

6967 Lake Forest Road
Baxter, MN 56425

T: (877) 687-5634
F: (218) 822-4044

www.ArrowwoodBrainerd.com

Your ideal choice for a Brainerd resort!

